

Montageanleitung

## Deckenhalterung VMC-LCD/CMB-1

Mounting Instructions

## Ceiling Mount Bracket VMC-LCD/CMB-1

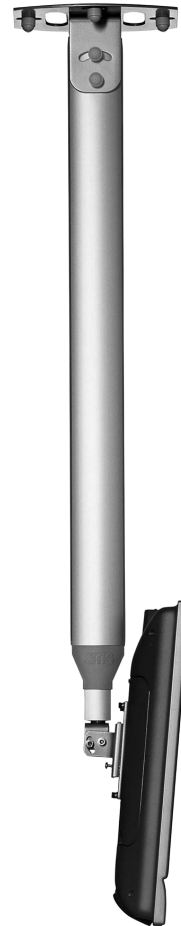

## Wichtig !

- Stellen Sie vor der Montage sicher, dass das Produkt fehlerfrei ist. Kontaktieren Sie bei sichtbaren Beschädigungen Ihren Händler.
- Überprüfen Sie vor der Montage des Produkts, ob alle Teile des Lieferumfangs vorhanden sind.
- Der Monteur muss sicherstellen, dass das Produkt korrekt am Untergrund befestigt wird und die Schrauben für den vorhandenen Untergrund geeignet sind.
- Es werden keine Schrauben mitgeliefert, die für den jeweiligen Untergrund optimiert sind.
- Stellen Sie sicher, dass alle Schrauben und Bolzen sicher befestigt sind, bevor das Produkt mit dem vollen Gewicht belastet wird.

## Deckenhalterung VMC-LCD/CMB-1, schwenk- und neigbar, für LCD-Monitore von 19" bis 30", EDV-Nr. 90449

### Allgemeine Beschreibung

- Für Deckenmontage von LCD-Monitoren
- Stufenlos fixierbarer Deckenabstand: 450 bis 650mm
- Monitor 360° schwenkbar
- Neigung bis max. 35°
- Max. Traglast: 15kg
- Robuste Aluminiumkonstruktion
- Einfache Installation

Die Deckenhalterung VMC-LCD/CMB-3 ist Zubehör von:	
EDV-Nr.	Kurzbeschreibung
90445	30" Prof. 16:9 TFT Farbmonitor, 4x FBAS
90447	23" Prof. 16:9 TFT Farbmonitor, 4x FBAS
90451	23" Prof. 16:9 TFT Farbmonitor, 4x FBA
90430	19" LCD-Industrie-Farbmonitor, 1280x1024 Pixel
90432	19" TFT/LCD-Farbmonitor, 1600x1200 Pixel
90446	17" Prof. 16:9 TFT Farbmonitor, 4x FBAS
90443	17" TFT-Farbmonitor, 1280x1024 Pixel
90393	17" Prof. TFT- (Industrie) -Farbmonitor, 1280x1024 Pixel
90399	17" TFT/LCD-Farbmonitor, 1280x1024 Pixel

# Montage

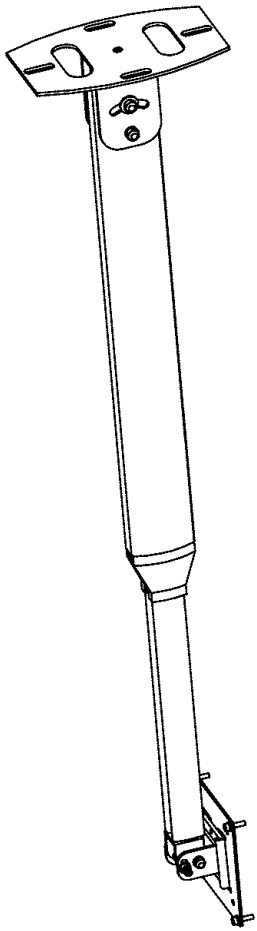

## Schritt 1

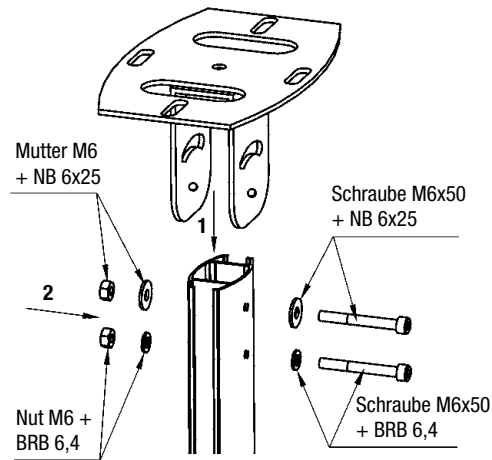

## Lochsablonen der Deckenplatte

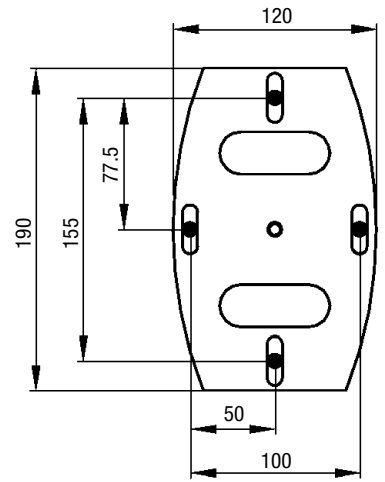

## Schritt 3

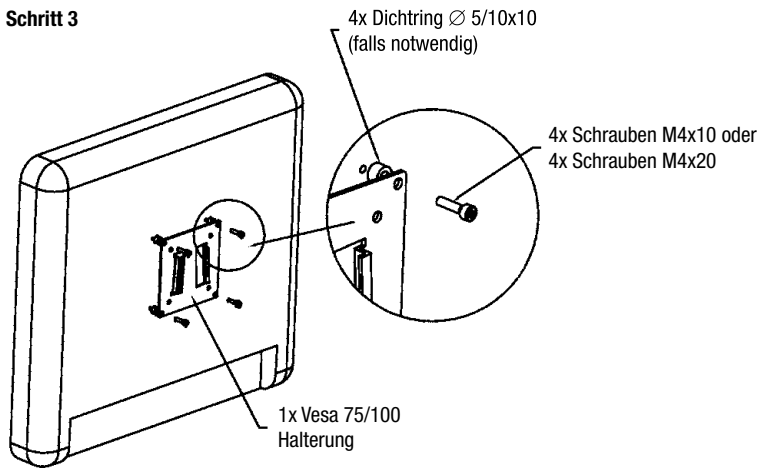

## Schritt 2

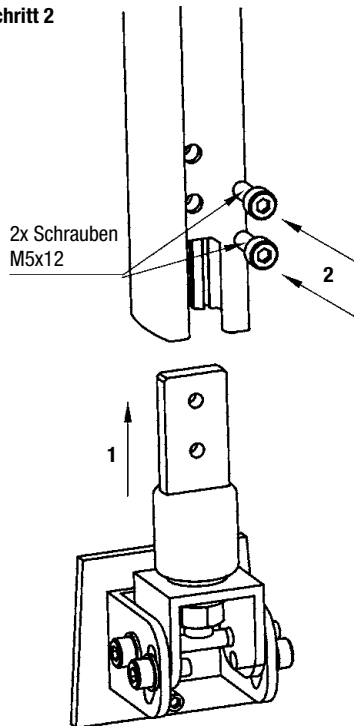

## Schritt 4

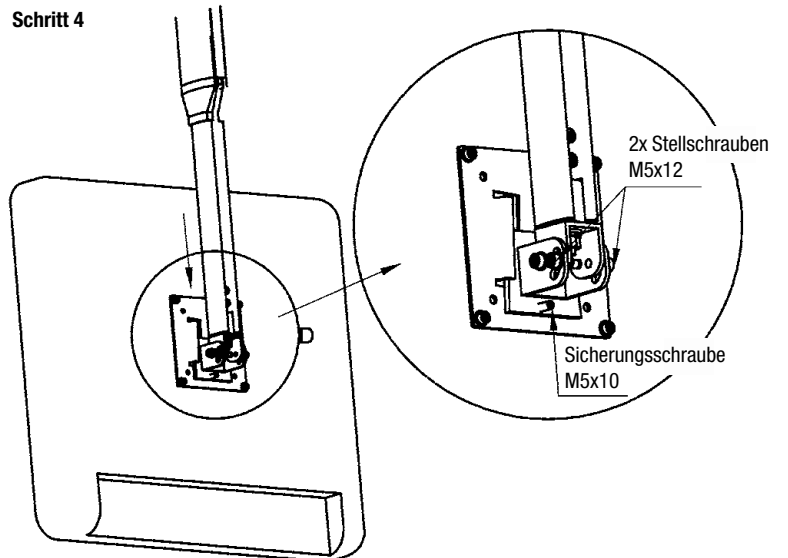

## Important !

- Make sure that the product is faultless prior to mounting. Should any damage be evident, please contact your supplier.
- Check that all parts are included in the package before mounting the product.
- The person conducting the installation has to ensure that the product is correctly mounted to the foundation and that screws suitable for the foundation are used.
- Screws optimized according to type of foundation are not included.
- Ensure that all screws and bolts are securely tightened before the product is saddled with full weight.

## Ceiling Mount Bracket, Pan and Tilttable for LCD Monitors 19" to 30", EDP No. 90449

### General Description

- For Ceiling Mount of LCD Monitors
- Stepless Vertical Extention (from 450 to 650mm)
- 360° Pan Range
- Tilt Range up to 35°
- Load Capacity: 15kg max.
- Rugged Aluminium Construction
- Ready for Installation

Accessory of	
EDP No.	Description
90445	30" Professional 16:9 TFT Colour Monitor, 4x CVBS
90447	23" Professional 16:9 TFT Colour Monitor, 4x CVBS
90451	23" Professional 16:9 TFT Colour Monitor, 4x CVBS
90430	19" LCD Profession. Colour Monitor, 1280x1024 pixels
90432	19" (48cm) TFT/LCD Colour Monitor with 1600x1200 pixels
90446	17" Professional 16:9 TFT Colour Monitor, 4x CVBS
90443	17" TFT Colour Monitor, 1280x1024 pixels
90393	17" TFT Professional Colour Monitor, 1280x1024 pixels
90399	17" (44cm) TFT/LCD Colour Monitor, 1280 pixels

# Mounting

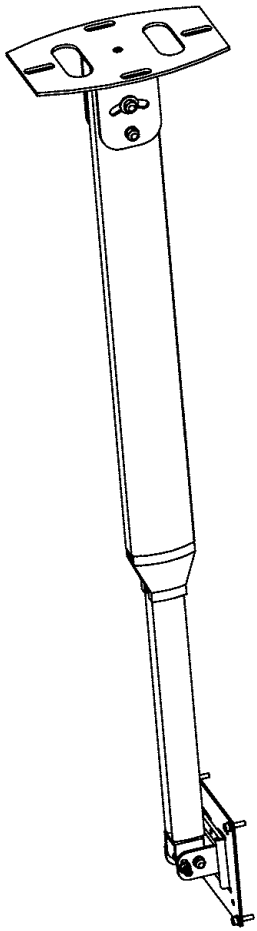

**Step 1**

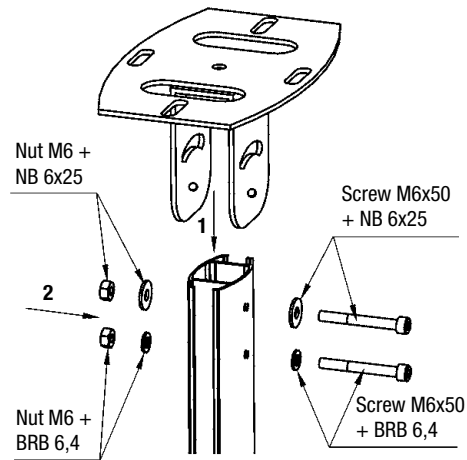

**Ceiling Plate Holes Pattern**

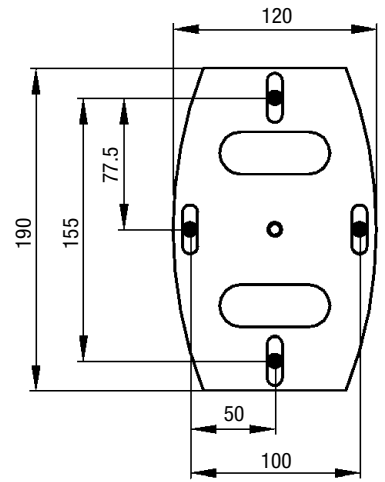

**Step 2**

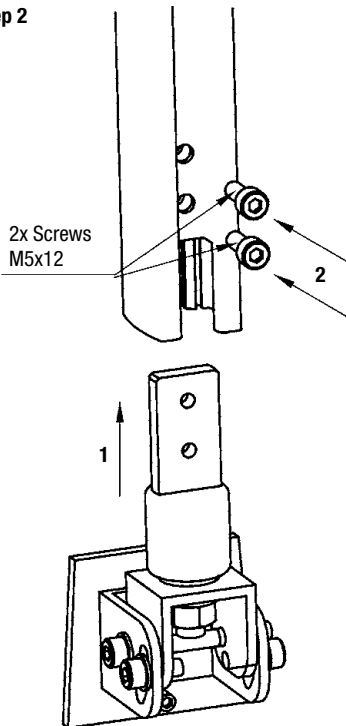

**Step 3**

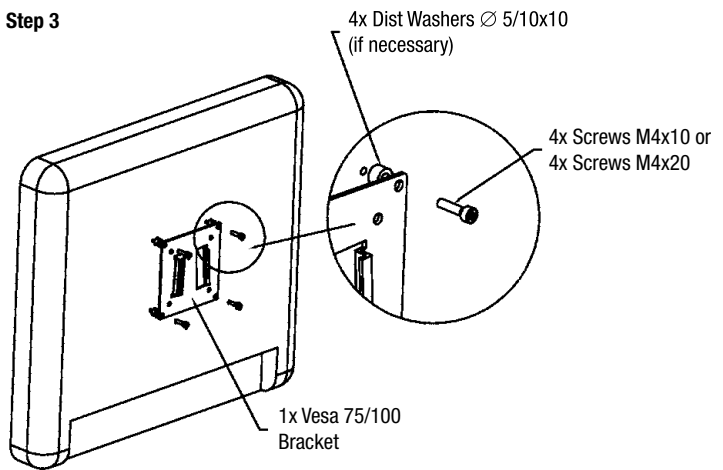

**Step 4**

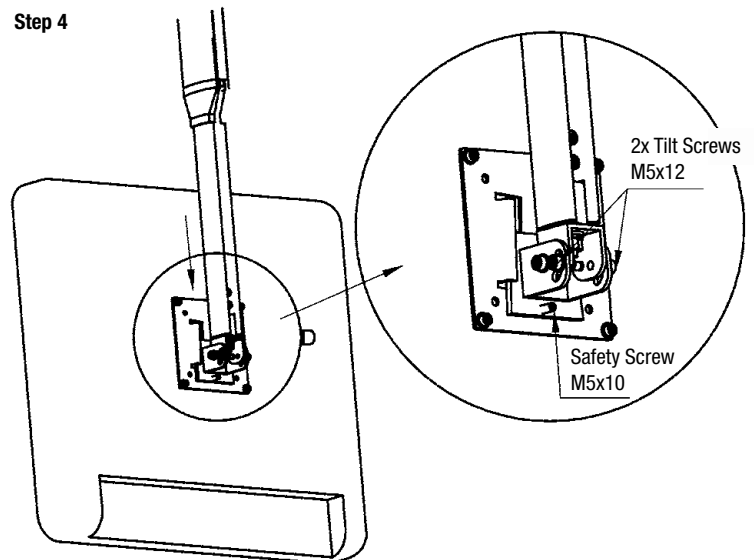



eneo® ist eine eingetragene Marke der Videor Technical E. Hartig GmbH  
Vertrieb ausschließlich über den Fachhandel.

eneo® is a registered trademark of Videor Technical E. Hartig GmbH  
Exclusive distribution through specialised trade channels only.

VIDEOR TECHNICAL E. Hartig GmbH  
Carl-Zeiss-Straße 8 · 63322 Rödermark/Germany  
Tel. +49 (0) 60 74 / 888-0 · Fax +49 (0) 60 74 / 888-100  
[www.videortechnical.com](http://www.videortechnical.com)



Technische Änderungen vorbehalten.  
Technical changes reserved.

© Copyright by VIDEOR TECHNICAL 11/04